



# Accessory Mount Bar for Landrover Defender

## Rear Mounting

### Product Details and Variations

A ingenious accessory to neatly mount your spot lamps, hazard warning lamps and Antennas with the minimum of fuss and weight. An alternative to mounting directly onto the bodywork, saves time, makes for efficiency and easily removed and transferred to a replacement vehicle leaving just 4 holes in the gutter.

Matching our range of front light bars the rear bars are elegantly simple, complementing the defender styling.



Rocard Light bars are not heavy, they don't need to be. It is designed to carry lamps and accessories which themselves are lightweight, even the heaviest work lamps are securely held in place. We don't believe in massively over-rating components, we understand that weight is an issue and we save more than 2.5 kg over a competitors product manufactured from heavy sections and end profiles. A Rocard rear light bar weighs less than 3kg.

The rear light bar has been designed to meet the very specific requirements of customers who have spent years working with defenders in the field. They will be outfitting a minimum of 10 vehicles at a time and that operation needs to be efficient, cost effective and wherever possible aesthetically pleasing. The Rocard rear light bar meets these criteria and the reduction in labour required to fit the required accessories to the rear end more than pays for the product.



Although there are standard configurations of nine and eleven brackets, white and black the rear light bar is often configured especially for the customers requirements, the number of brackets, the hole size and color of the unit may be specified. We are always open to altering designs to meet customers requirements.

As an additional feature we are now offering a set of reflectives for your lightbar, suitable for all models a red strip between brackets across the rear and silver reflective on the end plates. This increases safety and visibility in a discrete and effective manner.



Stainless steel hanks are press fitted during manufacture which aid installation and prevent corrosion thus allowing easy removal.

Powder coated versions are shot blasted prior to coating to ensure a durable and long lasting finish which will not lift if stone chips occur.

All welding is carried out by qualified professional personnel making for excellent strength and longevity.



Web: [www.roc-ard.co.uk](http://www.roc-ard.co.uk)  
Email: [info@roc-ard.co.uk](mailto:info@roc-ard.co.uk)  
Tel: 07402889543

Facebook: [www.facebook.com/rocardltd](http://www.facebook.com/rocardltd)  
Twitter: @RocArd\_UK





# Spot Light Mount Bar for Landrover Defender

## Rear Mounting

### Stock Variations and Specifications

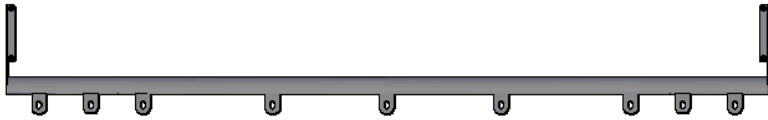

#### RLB9 STD BLK [WHT]

Seven 12.5 mm slotted brackets spaced as shown Black or [White] Powdercoat as standard.

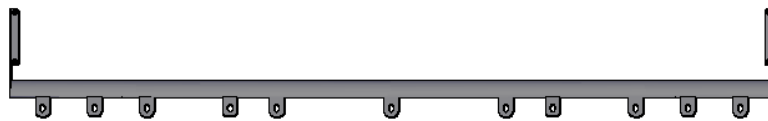

#### RLB11 STD BLK [WHT]

Nine 12.5 mm slotted brackets spaced as shown Black or [White] Powdercoat as standard.

The rear lightbar is stocked in both white and black satin powdercoat custom colours are available at additional cost of around £15 per unit with additional lead time. This depends on the quantity ordered and the chosen colour.

Brackets are 3mm thick and as standard have a 12.5mm clearance slotted hole. This accommodates hazard light and aerial requirements. Smaller 10mm version may be used on special orders.

Many clients will have a specific requirement for what they might want to install. As this is such a variety of parts on the market the number of brackets and spacings may need to be altered to meet your specific requirements. We encourage enquiries relating to custom products, very often when custom or bespoke is mentioned the price goes through the roof. That's not how it is here but custom configurations do require extra lead time. Special colour powder coating may cost extra as the stock prices are based on batch runs.

All light bars are supplied with four M6 Stainless Steel button headed fixings. Stainless Security bolt set is available at £5 each set. substitute STD for SEC in part number or order security bolt set separately.

